



Spacious and accessible. The Restaurant Building is located inside the Red Gate entrance on the north end of the fairgrounds. This 12,354 sq. ft. facility is an ideal location for auctions, bazaars, meetings and seminars. Easy public access to the building is available through any of the eleven entrances located around the building. Two 22' x 7' service entrances, gas heat, concession stands and concrete floor make this building a versatile and advantageous location for any event.

Building Features:

- Concession stand
- Show office space
- Telephone service available
- Gas heat
- Restrooms
- Easy access from Red Gate
- Nearby guest and/or public parking

Building Details

Square Footage:	12,858
Floor:	Concrete
Lighting:	400 watt, metal halide
Electrical:	120/208V 3 phase
Public Entrances:	Eleven - 6' x 6' 8"
Service Entrances:	Two - 22' x 7', one 9' x 8'
Other:	RV parking available nearby

Western Washington Fair Association

Facility/Event Services Manager
110 9th Ave SW • Puyallup, WA 98371-0162
Ph: (253) 841-5011 • Fax: (253) 841-5390
puyallueventscenter.com



Restaurant Bldg.

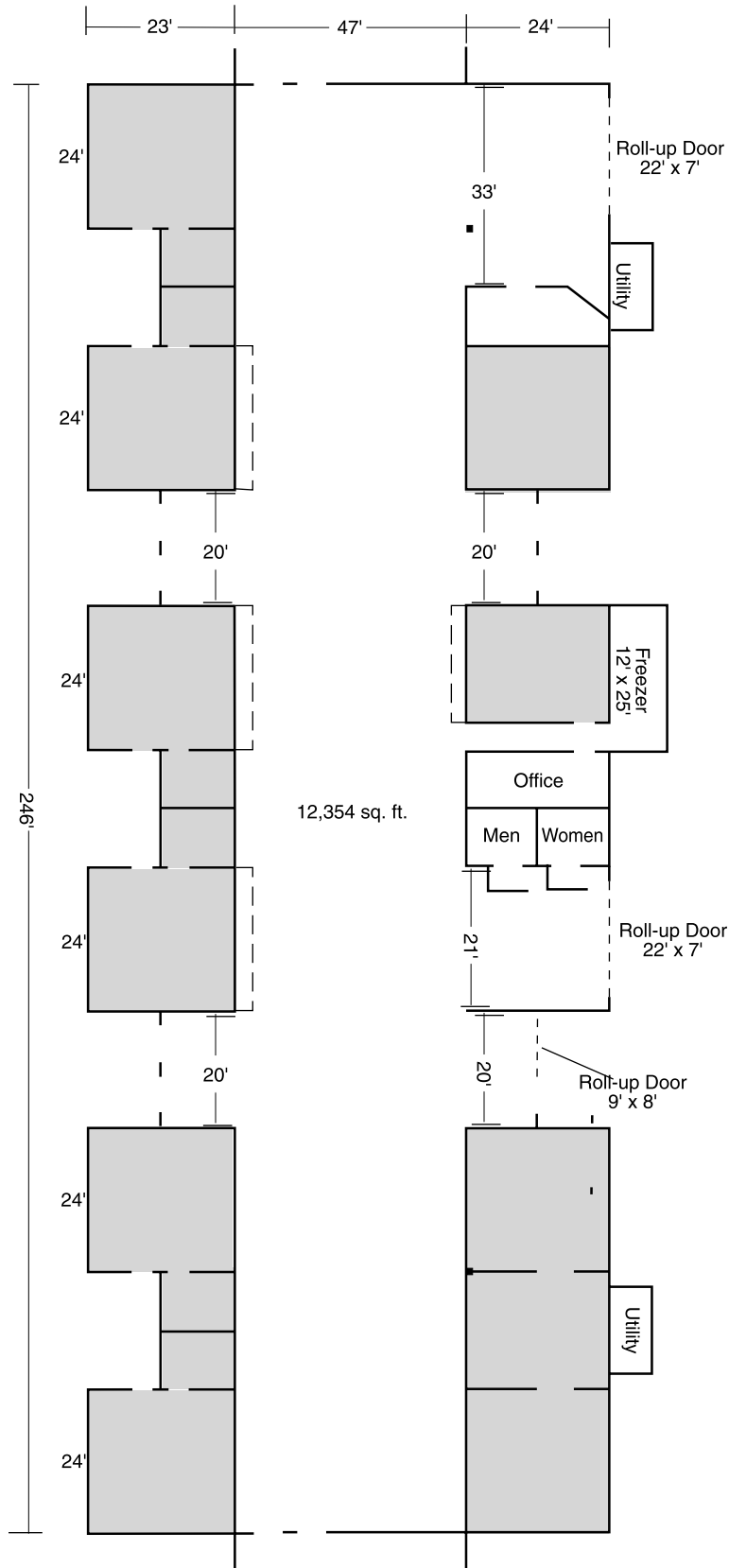

PUYALLUP FAIR
&
Events Center

Western Washington Fair Association
 Facility/Event Services Manager • 110 9th Ave SW • Puyallup, WA 98371-0162
 Ph: (253) 841-5011 • Fax: (253) 841-5390
puyallupeventscenter.com